

CR-24 TEMPORARY HANDRAIL

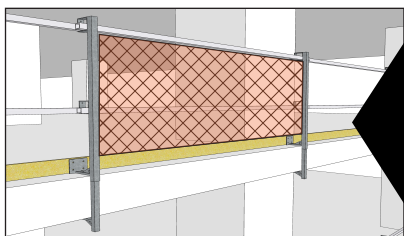

FOR USE WITH
OR WITHOUT
NETTING

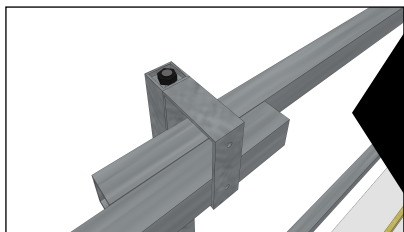

EASY ADJUST
SCREW DRIVE
OVERLAP TUBE
RAILS

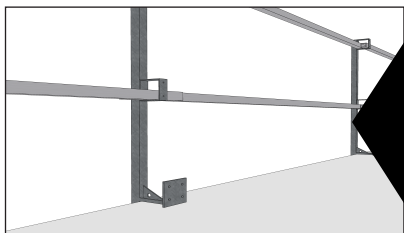

COMPATIBLE
WITH METAL
RAILS AND
CABLE

FEATURES & BENEFITS

- Durable galvanized steel
- Compatible with a wide range of concrete slabs
- Screw Drive Adjustment
- Resistant to corrosion
- Easy to install, easy to relocate as work progresses
- Made in the USA



SPECS

STANDARDS: OSHA 1910
OSHA 1926.502 (b)

MATERIALS:
Galvanized Steel

WEIGHT:
20 lbs.

SPECS & REQUIREMENTS

CR-24 Guardrail can be adjusted to fit concrete deck from 3" to 25" thick
Maximum permitted spacing between guardrails is 8 feet
Toprails must be 42" (+/-3") above the work surface or, if used in stilt work applications, 42" plus the height of stilts.

Toe-boards are required on surfaces with slopes more than 4/ 12 (vertical/horizontal).
Toe-boards must be a minimum of 3 1/2" from their top edge to the work surface. They must not have greater than 1/4" clearance between the bottom edge of the toeboard and the work surface.

CR-24 GUARDRAIL SLAB BRACKET ARE FOR THE FOLLOWING APPLICATIONS: FALL PREVENTION

The Safeline-FP Series-24 Guardrail Slab Bracket System may be used in Fall Prevention applications ONLY. Fall Prevention Systems are placed around the leading edge where fall hazards exist and may be used in substitute of fall protection or netting systems. Installation requirements for the Safeline-FP Series-24 Guardrail Slab Bracket System MUST be adhered to. Fall Arrest, Climbing, Work positioning, Scaffolding, Rescue or any other system must NEVER be connected to the CR-24 Fall Prevention Systems at any time.

Made in the USA

For more information, please call 410-218-5371 or visit www.safelinefp.com.



Need More Information? Visit us at: www.safelinefp.com or call 410-218-5371